

SWITCHING DIODE

FEATURES

- High voltage, high speed switching applications
- Low forward voltage
- Fast reverse recovery time
- Small total capacitance

MAKING: F5

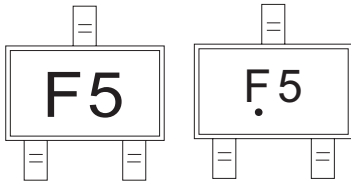

Solid dot = Green molding compound device, if none, the normal device.

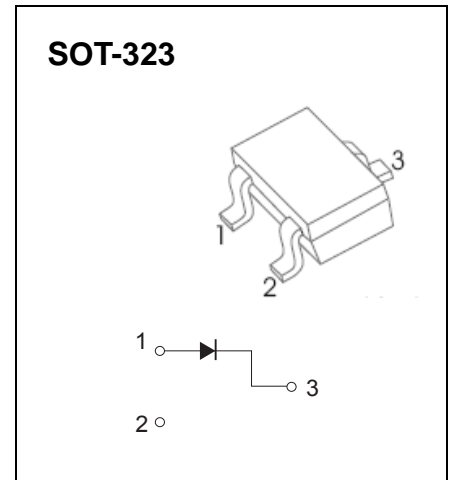

Maximum Ratings @Ta=25°C

Parameter	Symbol	Limit	Unit
Peak reverse voltage	$V_{RM}$	250	V
DC reverse voltage	$V_R$	200	V
Peak forward current	$I_{FM}$	300	mA
Mean rectifying current	$I_o$	100	mA
Non-Repetitive Peak Forward Surge current@t=8.3ms	$I_{FSM}$	2.0	A
Junction temperature	$T_j$	150	°C
Storage temperature	$T_{stg}$	-55~+150	°C

Electrical Ratings @Ta=25°C

Parameter	Symbol	Min	Typ	Max	Unit	Conditions
Forward voltage	$V_F$			1	V	$I_F=10mA$
				1.2	V	$I_F=100mA$
Reverse current	$I_R$			0.1	$\mu A$	$V_R=50V$
				1	$\mu A$	$V_R=200V$
Capacitance between terminals	$C_T$			3.0	pF	$V_R=0, f=1MHZ$
Reverse recovery time	$t_{rr}$		60		ns	$V_R=6V, I_F=10mA, I_{rr}=0.1*I_R$



### Typical Characteristics

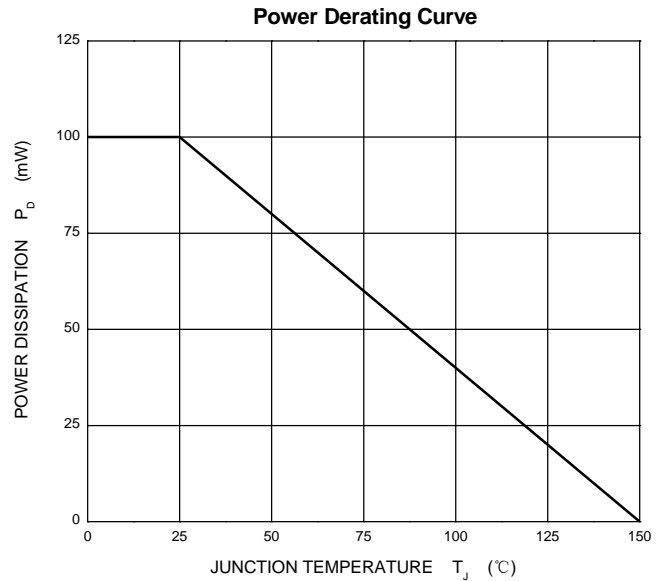
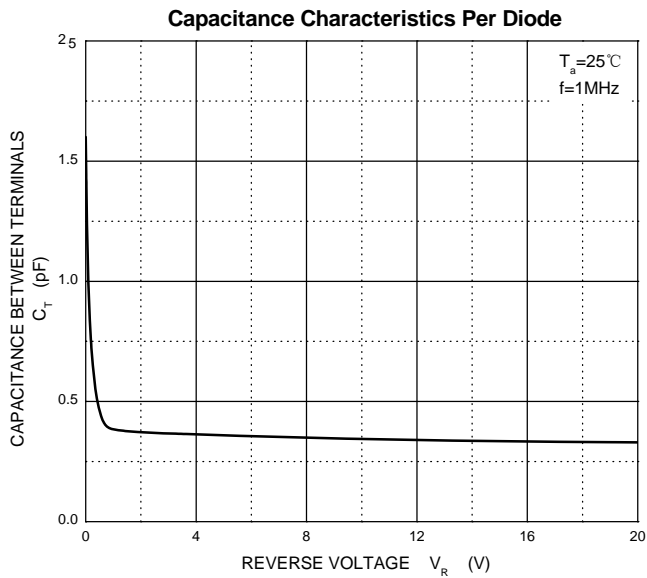
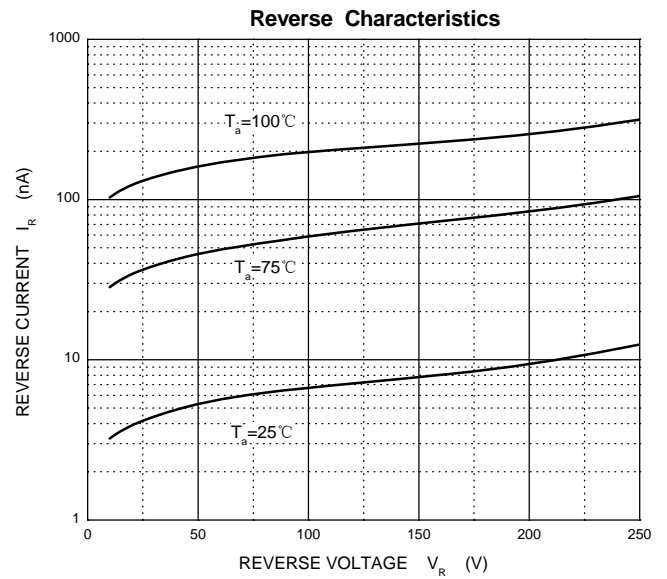
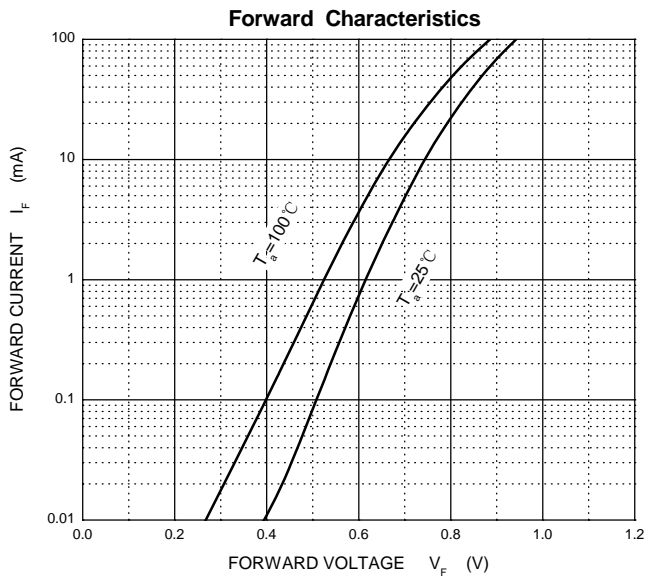

SOT-323 Package Outline Dimensions

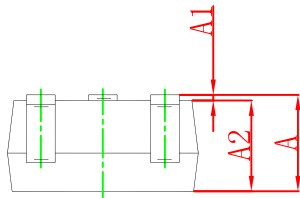
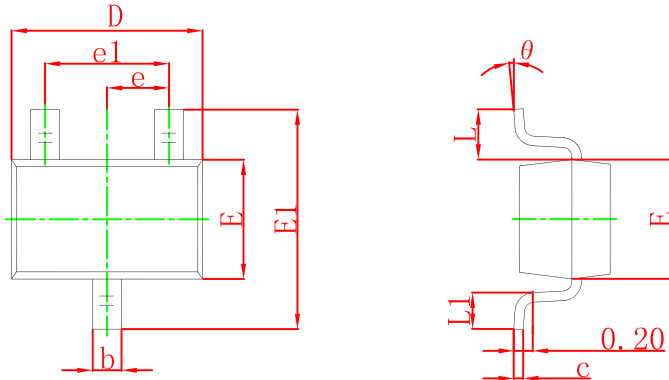

Symbol	Dimensions In Millimeters		Dimensions In Inches	
	Min	Max	Min	Max
A	0.900	1.100	0.035	0.043
A1	0.000	0.100	0.000	0.004
A2	0.900	1.000	0.035	0.039
b	0.200	0.400	0.008	0.016
c	0.080	0.150	0.003	0.006
D	2.000	2.200	0.079	0.087
E	1.150	1.350	0.045	0.053
E1	2.150	2.450	0.085	0.096
e	0.650 TYP		0.026 TYP	
e1	1.200	1.400	0.047	0.055
L	0.525 REF		0.021 REF	
L1	0.260	0.460	0.010	0.018
θ	0°	8°	0°	8°

SOT-323 Suggested Pad Layout

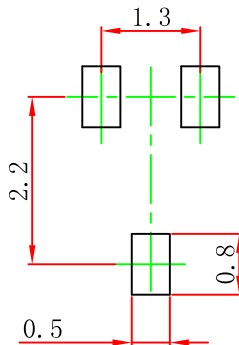

Note:  
 1. Controlling dimension: in millimeters.  
 2. General tolerance: ±0.05mm.  
 3. The pad layout is for reference purposes only.